

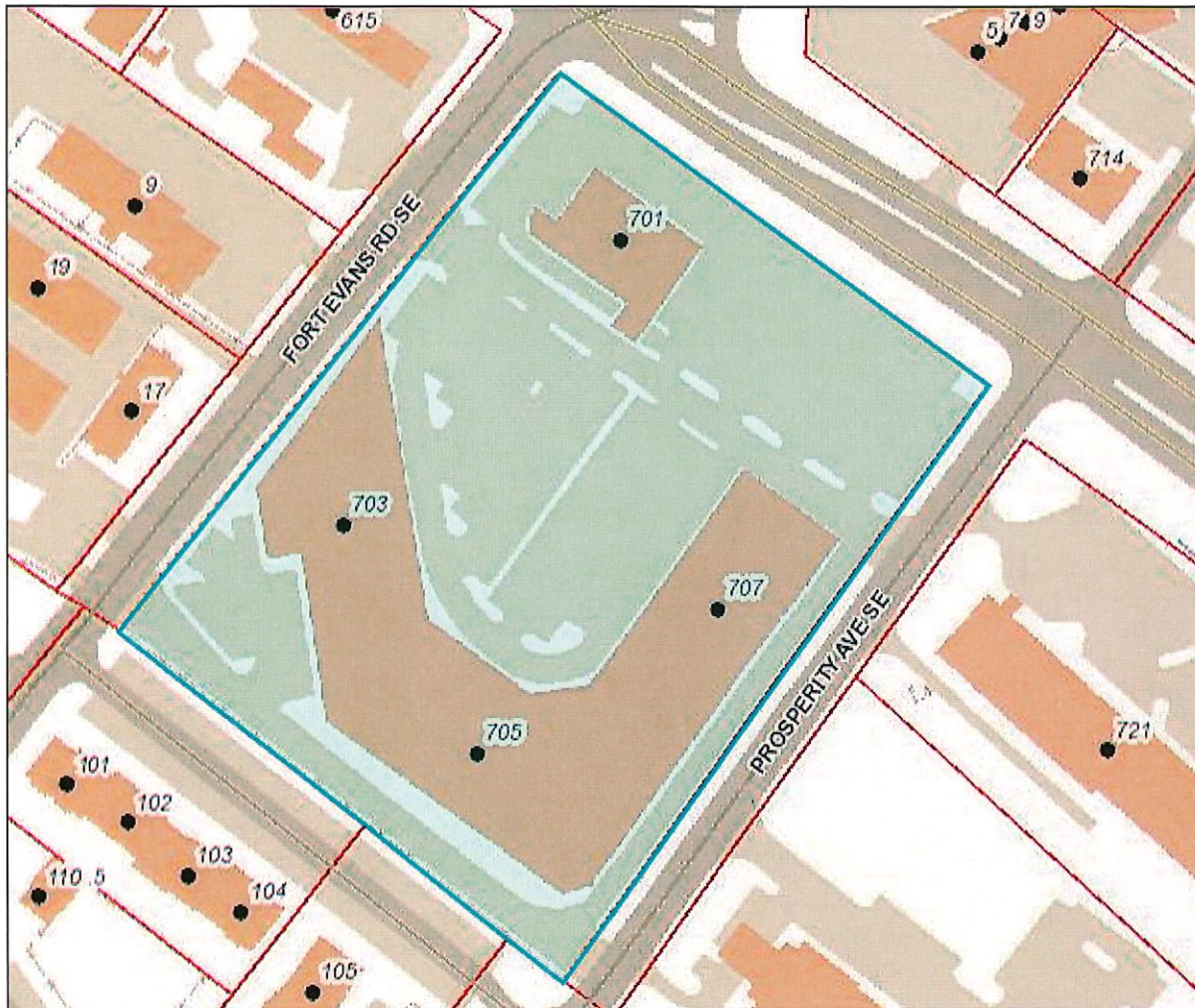

Loudoun County, Virginia
www.loudoun.gov

Wednesday, March 28, 2018

(map not to scale)



AUTOZONE SHOPPING CENTER
MAIN ADDRESS: 701 EAST MARKET ST.
PIN #: 189-46-7155-000
CSP: TLSP-2012-0074, 0101 & 0102

ZONING DISTRICT: 701&707 CD-CC
703&705 CD-C

Property Search Loudoun.gov

- Profile
- Values
- Sales / Transfers
- Land
- Land Use Status
- Residential
- Detached Structures
- Commercial
- Map
- WebLogis
- Aerial Photos
- Tax History / Payment
- Parcel Tracking

PARID: 189467155000
 PROSPERITY CENTER LLC, 701 MARKET ST E

1 of 1

Owner	
Name	PROSPERITY CENTER LLC
Care Of	RAPPAPORT
Mailing Address	8605 WESTWOOD CENTER DR STE 410
.	
.	VIENNA VA 22182
Instrument Number	201306240052201
Book	
Page	

Actions

- Neighborhood
- Sales
- Printable
- Summary
- Printable Version

Parcel	
Primary Address	701 MARKET ST
Tax Map #	148/15/11/1
State Use Class	Commercial/Indust
Total Land Area (Acreage)	5.5
Total Land Area (SQFT)	
Election District	LEESBURG
Billing District	Leesburg Town
Billing Split Notes 1	
Billing Split Notes 2	
Special Ad Valorem Tax District	None
Special Project District	
Neighborhood	429
Living Units	
Structure Occupancy	SHOPPING CENTER
Condominium Garage Unit or Parking Space	NO
Subdivision	PROSPERITY CENTER
Affordable Dwelling Unit (Y/N)	N
Ag District	N/A
Ag District Starting Date	
Ag District End Date	
Deactivation Status	

Legal Description	
Legal Description	PROSPERITY CENTER L.1
.	200709190068345
.	

General Information

Loudoun County is providing public record information as a public service in accordance with Virginia Code Title 58.1-3122.2 (1998). The Loudoun County Commissioner of the Revenue provides annual valuations and maintenance of fair market values for equitable assessments on all types of real property.

The property information made available on this site includes ownership and deed information, legal description, sales information, assessment values and house characteristics and can be searched by Parcel ID Number, Address and Tax Map Number. The site is updated weekly. Parcels are linked to the Loudoun County GIS, with map overlays displaying boundary and environmental information such as topography, soils, flood plain and major roads.

Condominium garage units or assigned parking spaces associated with condominiums may have separate parcel identification numbers - and may be assessed separately.

Tax History / Payment

Click on the Parcel ID to view its related document
[189467155000](#)

Location Google Map
 1 Harrison St, S.E., 5th Floor,

Contact Us
 Phone: (703) 777-0260
 Fax: (703) 771-5234

Site Links
[Loudoun.gov](#)