

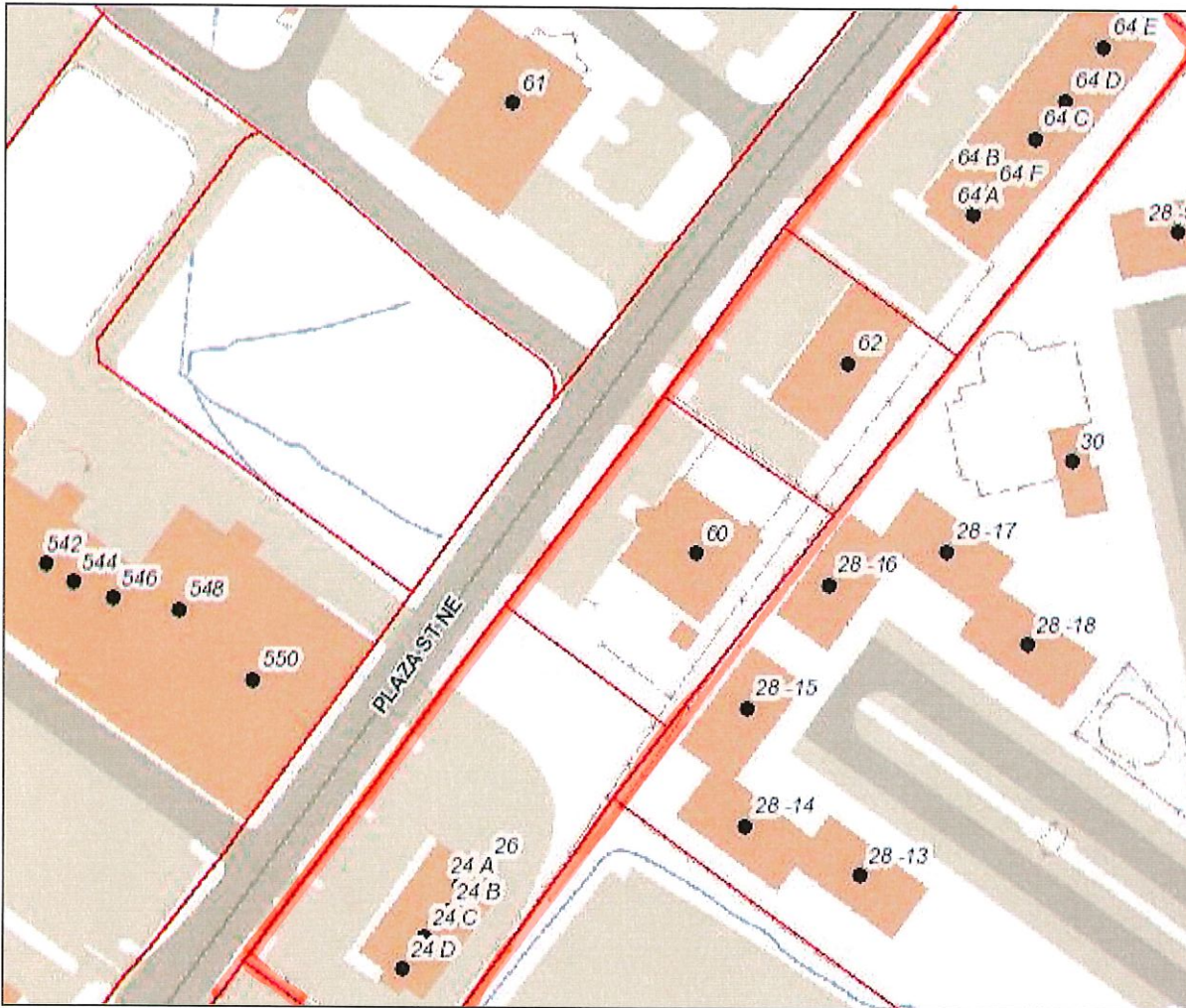

Loudoun County, Virginia
www.loudoun.gov

Monday, June 4, 2018

(map not to scale)



PLAZA COURT I
(24A-26, 62, 64A-64F) PLAZA STREET NE
CSP: NO CSP

ZONING DISTRICT:CD-C



Loudoun County, Virginia
www.loudoun.gov

Monday, June 4, 2018

(map not to scale)

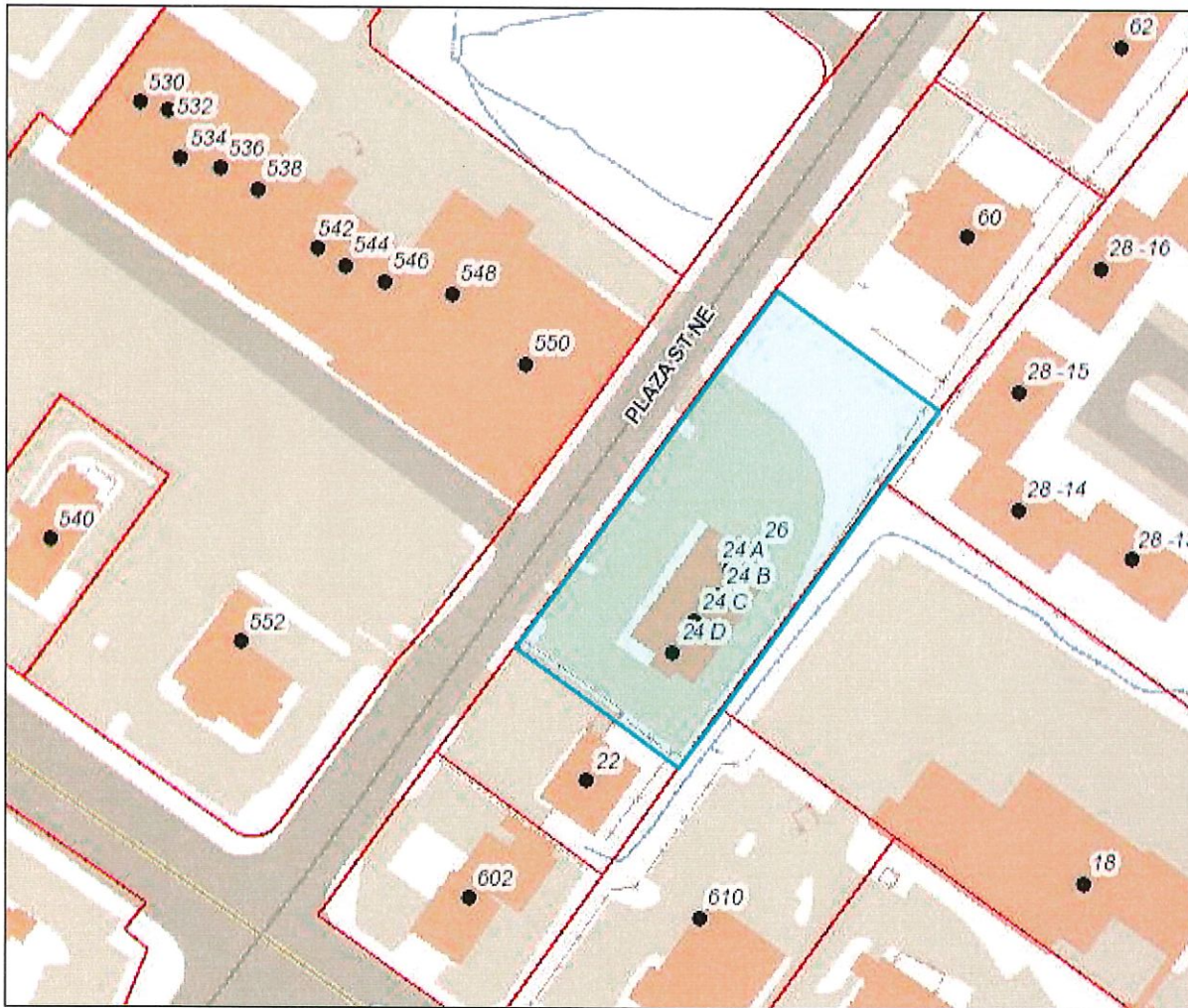

PLAZA COURT I (LOT 1)
ADDRESS: 24A PLAZA STREET NE (24(A-D)-26)
PIN #: 188-16-6654-000
CSP: NO CSP

ZONING DISTRICT: CD-C

Property Search Loudoun.gov

- Profile
- Values
- Sales / Transfers
- Land
- Land Use Status
- Residential
- Detached Structures
- Commercial
- Map
- WebLogis
- Aerial Photos
- Tax History / Payment
- Parcel Tracking

PARID: 188166654000
 SAEIDI, ASLAN & KATAYOUN TRUSTEES, 24 PLAZA ST

1 of 1

Owner

Name SAEIDI, ASLAN & KATAYOUN TRUSTEES
 Care Of A & K SAEIDI REV TRUSTS
 Mailing Address 43462 FIRESTONE PL
 LEESBURG VA 20176-3917
 Instrument Number 200812050070915
 Book
 Page

Actions

- Neighborhood
- Sales
- Printable
- Summary
- Printable Version

Parcel

Primary Address 24 A PLAZA ST
 Tax Map # 14811711111
 State Use Class Commercial/Indust
 Total Land Area (Acreage) 1.12
 Total Land Area (SQFT)
 Election District LEESBURG
 Billing District Leesburg Town
 Billing Split Notes 1
 Billing Split Notes 2
 Special Ad Valorem Tax District None
 Special Project District
 Neighborhood 410
 Living Units
 Structure Occupancy OFFICE BUILDING
 Condominium Garage Unit or Parking Space NO
 Subdivision PLAZA COURT
 Affordable Dwelling Unit (Y/N) NO: PROPERTY IS NOT ADU.
 Ag District
 Ag District Starting Date
 Ag District End Date
 Deactivation Status

Legal Description

Legal Description PLAZA COURT I LOT 1
 200812050070915 1744--349

General Information

Loudoun County is providing public record information as a public service in accordance with Virginia Code Title 58.1-3122.2 (1998). The Loudoun County Commissioner of the Revenue provides annual valuations and maintenance of fair market values for equitable assessments on all types of real property.

The property information made available on this site includes ownership and deed information, legal description, sales information, assessment values and house characteristics and can be searched by Parcel ID Number, Address and Tax Map Number. The site is updated weekly. Parcels are linked to the Loudoun County GIS, with map overlays displaying boundary and environmental information such as topography, soils, flood plain and major roads.

Condominium garage units or assigned parking spaces associated with condominiums may have separate parcel identification numbers - and may be assessed separately.

Tax History / Payment

Click on the Parcel ID to view its related document
[188166654000](#)

Location  Google Map
 1 Harrison St, S.E., 5th Floor,

Contact Us
 Phone: (703) 777-0260
 Fax: (703) 771-5234

Site Links
[Loudoun.gov](#)



Loudoun County, Virginia
www.loudoun.gov

Monday, June 4, 2018

(map not to scale)

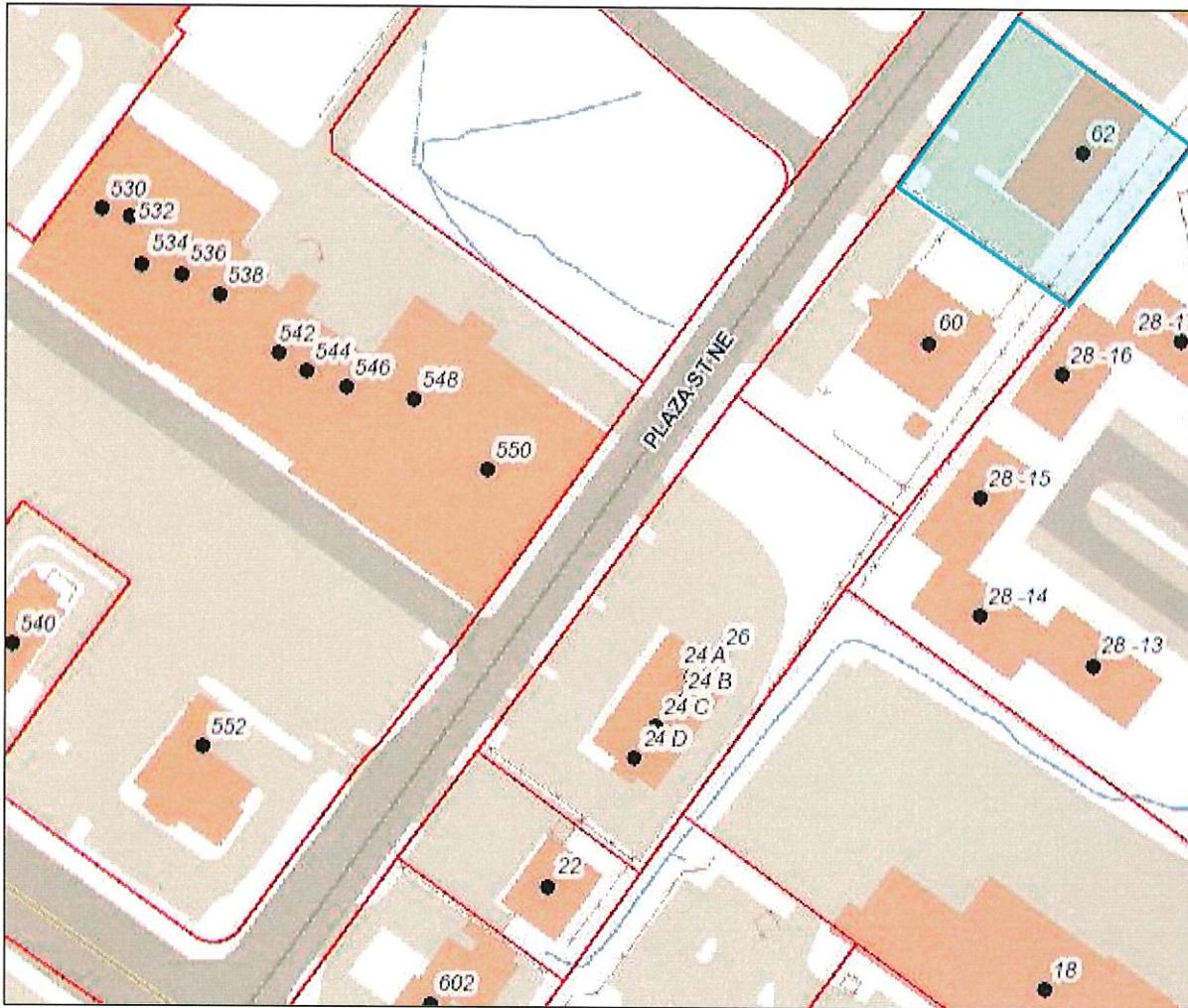

PLAZA COURT I (LOT 3)
ADDRESS: 62 PLAZA STREET NE
PIN #: 188-16-9389-000
CSP: NO CSP

ZONING DISTRICT: CD-C

Property Search Loudoun.gov

- [Profile](#)
- [Values](#)
- [Sales / Transfers](#)
- [Land](#)
- [Land Use Status](#)
- [Residential](#)
- [Detached Structures](#)
- [Commercial](#)
- [Map](#)
- [WebLogis](#)
- [Aerial Photos](#)
- [Tax History / Payment](#)
- [Parcel Tracking](#)

PARID: 188169389000
 CBJOHNSON LLC, 62 PLAZA ST

1 of 1

Owner

Name CBJOHNSON LLC
 Care Of
 Mailing Address 14906 CRANOKE RD
 . CENTREVILLE VA 20120-1532
 Instrument Number 201205110035721
 Book
 Page

- Actions**
- Neighborhood
 - Sales
 - Printable
 - Summary
 - Printable Version

Parcel

Primary Address 62 PLAZA ST
 Tax Map # 14811711113
 State Use Class Commercial/Indust
 Total Land Area (Acreage) .51
 Total Land Area (SQFT)
 Election District LEESBURG
 Billing District Leesburg Town
 Billing Split Notes 1
 Billing Split Notes 2
 Special Ad Valorem Tax District None
 Special Project District
 Neighborhood 428
 Living Units
 Structure Occupancy SHOPPING CENTER
 Condominium Garage Unit or Parking Space NO
 Subdivision PLAZA COURT
 Affordable Dwelling Unit (Y/N) NO: PROPERTY IS NOT ADU.
 Ag District
 Ag District Starting Date
 Ag District End Date
 Deactivation Status

Legal Description

Legal Description PLAZA COURT I LOT 3
 2326--1535 998--1167

General Information

Loudoun County is providing public record information as a public service in accordance with Virginia Code Title 58.1-3122.2 (1998). The Loudoun County Commissioner of the Revenue provides annual valuations and maintenance of fair market values for equitable assessments on all types of real property.

The property information made available on this site includes ownership and deed information, legal description, sales information, assessment values and house characteristics and can be searched by Parcel ID Number, Address and Tax Map Number. The site is updated weekly. Parcels are linked to the Loudoun County GIS, with map overlays displaying boundary and environmental information such as topography, soils, flood plain and major roads.

Condominium garage units or assigned parking spaces associated with condominiums may have separate parcel identification numbers - and may be assessed separately.

Tax History / Payment

Click on the Parcel ID to view its related document
[188169389000](#)

Location Google Map
 1 Harrison St, S.E., 5th Floor,

Contact Us
 Phone: (703) 777-0260
 Fax: (703) 771-5234

Site Links
[Loudoun.gov](#)



Loudoun County, Virginia
www.loudoun.gov

Monday, June 4, 2018

(map not to scale)

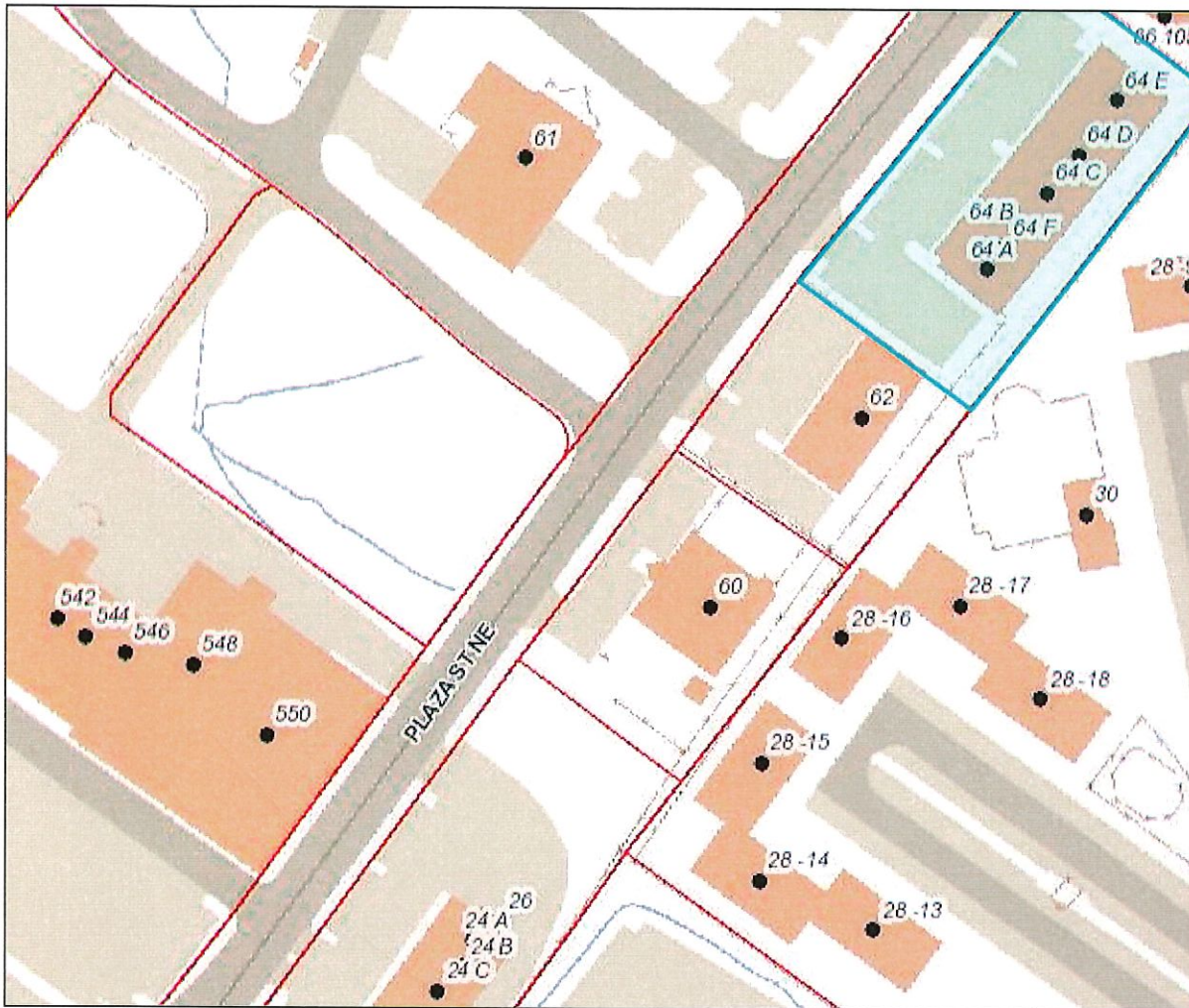

PLAZA COURT I (LOT 4)
ADDRESS: 64 PLAZA STREET NE (64 A-F)
PIN #: 188-27-0808-000
CSP: NO CSP

ZONING DISTRICT: CD-C

Property Search Loudoun.gov

Profile	PARID: 188270808000	64 PLAZA ST
Values	RIBOL LLC,	
Sales / Transfers	Owner	
Land	Name	RIBOL LLC
Land Use Status	Care Of	
Residential	Mailing Address	64 PLAZA ST NE STE A
Detached Structures		LEESBURG VA 20176-3247
Commercial	Instrument Number	201009090054620
Map	Book	
WebLogis	Page	
Aerial Photos	Parcel	
Tax History / Payment	Primary Address	64 A PLAZA ST
Parcel Tracking	Tax Map #	14811711111A1
	State Use Class	Commercial/Indust
	Total Land Area (Acreage)	1.02
	Total Land Area (SQFT)	
	Election District	LEESBURG
	Billing District	Leesburg Town
	Billing Split Notes 1	
	Billing Split Notes 2	
	Special Ad Valorem Tax District	None
	Special Project District	
	Neighborhood	428
	Living Units	
	Structure Occupancy	SHOPPING CENTER
	Condominium Garage Unit or Parking Space	NO
	Subdivision	PLAZA COURT
	Affordable Dwelling Unit (Y/N)	NO: PROPERTY IS NOT ADU.
	Ag District	
	Ag District Starting Date	
	Ag District End Date	
	Deactivation Status	

1 of 1

Actions

- Neighborhood
- Sales
- Printable
- Summary
- Printable Version

Parcel	
Primary Address	64 A PLAZA ST
Tax Map #	14811711111A1
State Use Class	Commercial/Indust
Total Land Area (Acreage)	1.02
Total Land Area (SQFT)	
Election District	LEESBURG
Billing District	Leesburg Town
Billing Split Notes 1	
Billing Split Notes 2	
Special Ad Valorem Tax District	None
Special Project District	
Neighborhood	428
Living Units	
Structure Occupancy	SHOPPING CENTER
Condominium Garage Unit or Parking Space	NO
Subdivision	PLAZA COURT
Affordable Dwelling Unit (Y/N)	NO: PROPERTY IS NOT ADU.
Ag District	
Ag District Starting Date	
Ag District End Date	
Deactivation Status	

Legal Description	
Legal Description	PLAZA COURT I LOT 4 201009090054620

General Information

Loudoun County is providing public record information as a public service in accordance with Virginia Code Title 58.1-3122.2 (1998). The Loudoun County Commissioner of the Revenue provides annual valuations and maintenance of fair market values for equitable assessments on all types of real property.

The property information made available on this site includes ownership and deed information, legal description, sales information, assessment values and house characteristics and can be searched by Parcel ID Number, Address and Tax Map Number. The site is updated weekly. Parcels are linked to the Loudoun County GIS, with map overlays displaying boundary and environmental information such as topography, soils, flood plain and major roads.

Condominium garage units or assigned parking spaces associated with condominiums may have separate parcel identification numbers - and may be assessed separately.

Tax History / Payment

Click on the Parcel ID to view its related document
[188270808000](#)

Location Google Map
 1 Harrison St, S.E., 5th Floor,

Contact Us
 Phone: (703) 777-0260
 Fax: (703) 771-5234

Site Links
[Loudoun.gov](#)